

Introduction

Thank you for purchasing AVerMedia® AVerDVR TV2VGA. AVerDVR TV2VGA converter is an inexpensive solution for DVR that only support TV output to display video on LCD/CRT monitor. It supports PAL and NTSC video systems and provides up to 1280 x 1024, 60~85Hz.

AVerDVR TV2VGA is easy to install and use. Control buttons are provided for easy screen positioning and adjustment.

Package Contents

- ☐ AVerMedia® AVerDVR TV2VGA
- ☐ Power adapter
- ☐ Manual

Hardware Connection

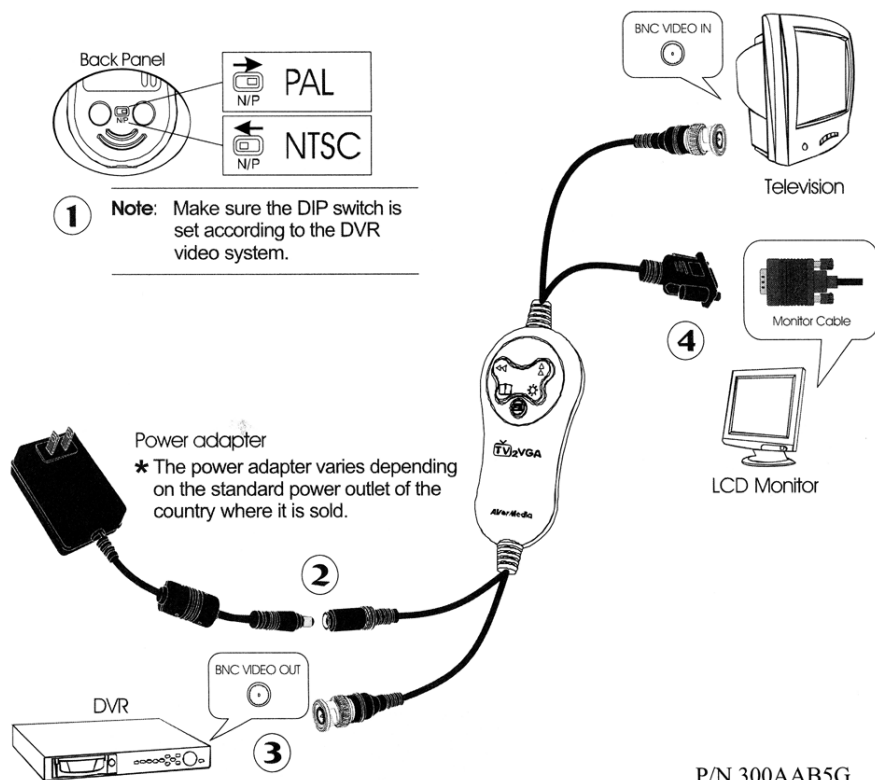

P/N 300AAB5G
Made in Taiwan

Control Buttons

	Move the picture to the left. The picture would automatically return to the rightmost of the screen when it reaches the end.
	Move the picture up. The picture would automatically return at the bottom of the screen when it reaches the end.
	Press to cycle through 9 contrast levels.
	Press to cycle through 9 brightness levels.
	<ul style="list-style-type: none"> - Call up the picture menu. - Press for about 6 sec. to restore to its original factory picture setting.

Picture Menu

Press to call up the picture menu. Then, use to select the desired function and use to adjust. The table below lists the picture menu items and their available settings.

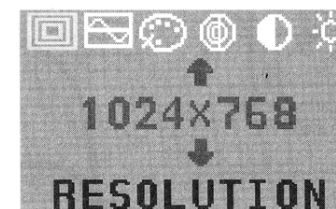

Note : When the LCD monitor does not support the new setting, the screen normally turns blank. Just continue pressing to select other settings.

RESOLUTION	FREQUENCY	HUE	SATURATION	CONTRAST	BRIGHTNESS
640 x 480	60 Hz	Support	Support	Support	Support
800 x 600	70 Hz	9 levels	9 levels	9 levels	9 levels
1024 x 768	72 Hz				
1280 x 1024	75 Hz				
	85 Hz				

<http://www.avermedia.com>

